

1/2" x 1 1/4" WOOD STAIR STRINGER ATTACHED TO WALL STUDS IN WALLS SURROUNDING STAIRWELL, TYPICAL

1/2" x 1 1/4" WOOD DIAGONAL SUPPORT ATTACHED TO SIDE STRINGERS OF STAIR AND SUPPORTING ENDS OF MIDDLE STAIR STRINGERS

SCALE: 1" = 1'-0"

1



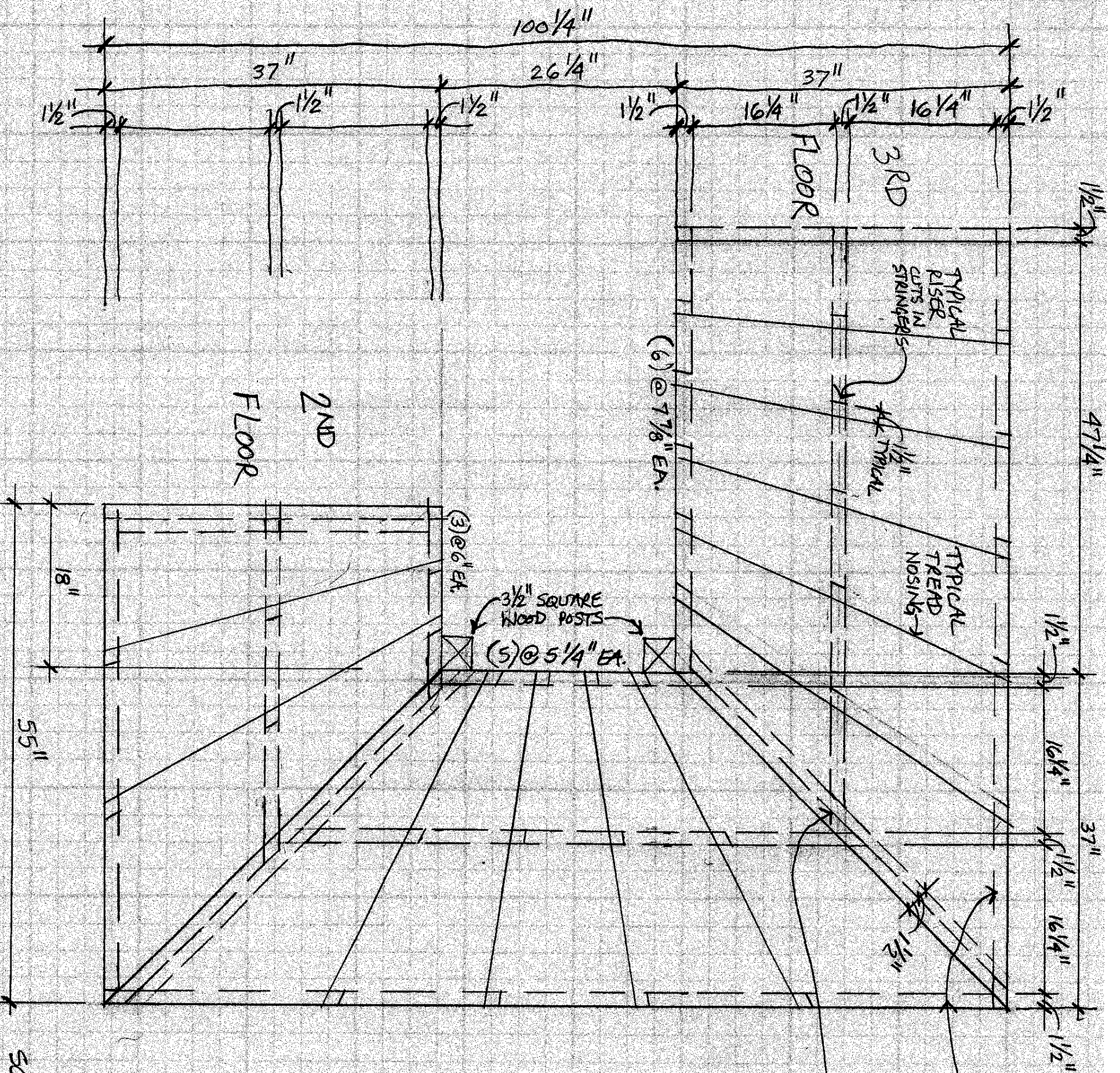

SCALE: 1" = 1'-0"

1/2" x 1 1/4" wood stair stringer attached to wall studs in walls surrounding stairwell, typical

1/2" x 1 1/4" wood diagonal support attached to side stringers of stair and supporting ends of middle stair stringers

typical riser cuts in stringers

typical tread nosing

typical

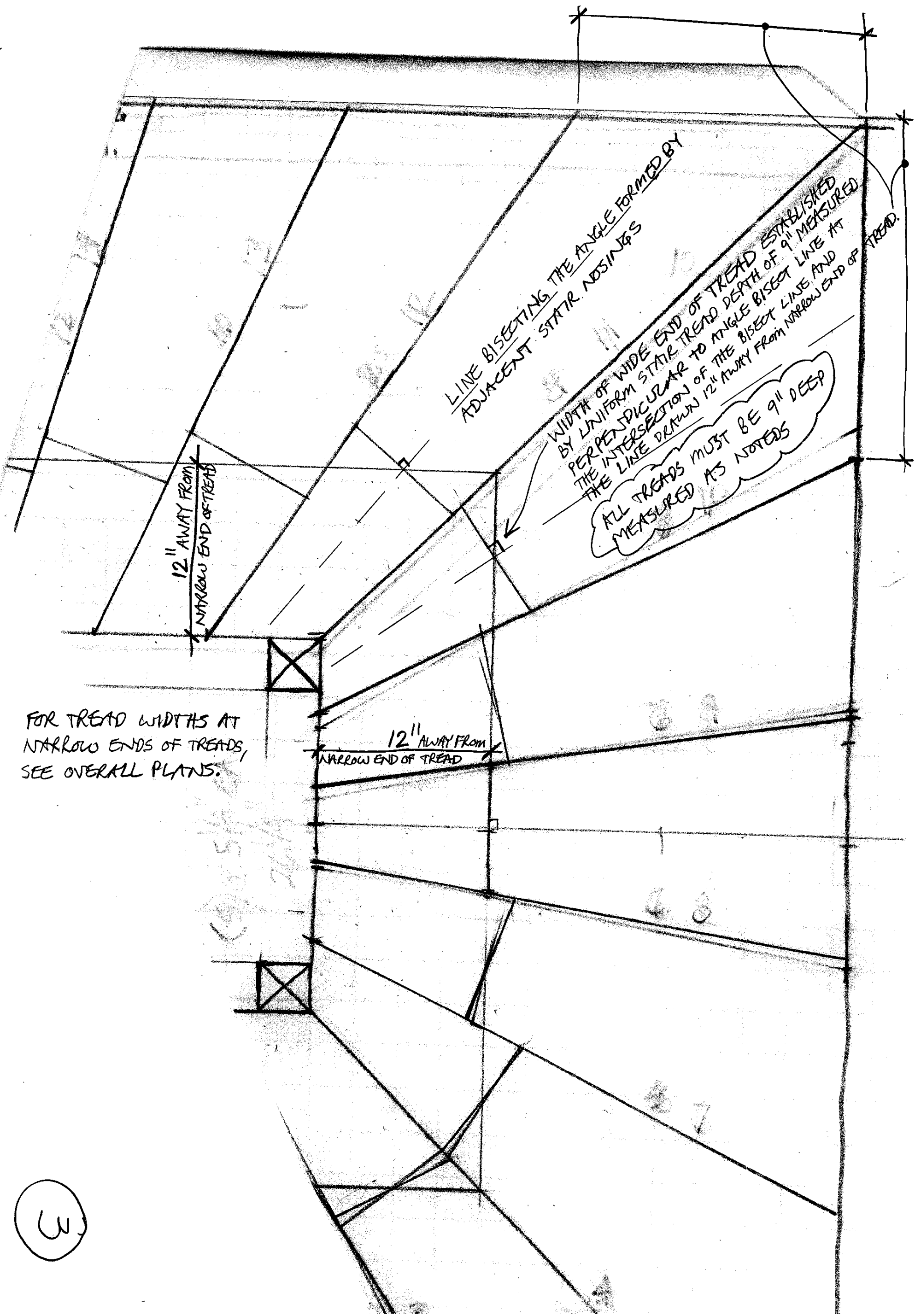

LINE BISECTING THE ANGLE FORMED BY  
ADJACENT STAIR NOSINGS

WIDTH OF WIDE END OF TREAD ESTABLISHED  
BY UNIFORM STAIR TREAD DEPTH OF 9" MEASURED  
PERPENDICULAR TO ANGLE BISECT LINE AT  
THE INTERSECTION OF THE BISECT LINE AND  
THE LINE DRAWN 12" AWAY FROM NARROW END OF  
TREAD.

ALL TREADS MUST BE 9" DEEP  
MEASURED AS NOTED

12" AWAY FROM  
NARROW END OF TREAD

12" AWAY FROM  
NARROW END OF TREAD

FOR TREAD WIDTHS AT  
NARROW ENDS OF TREADS,  
SEE OVERALL PLANS.

(3)