



Range Hoods with P-System



“Typically when installing a furniture-style range hood in a kitchen project, it's one of the last items to be installed. The P-system connectors allow us to construct and install a fastener-free final product. Additionally, the P-system connectors allow us to have accessibility to the initial connections of blower motor, ducting, and electrical as well as maintain access for homeowner maintenance down the road.”

Matt Moore, Owner, Matt Moore Designs, Jacksonville, FL

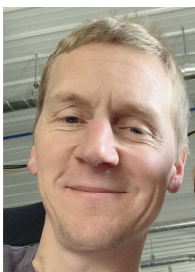

“The Lamello P-System works wonders for many range hood designs. It allows the hood to be built, but enables the front to be popped off, giving the hvac installer access to properly fit, elbow, and tape off the piping for the blower fan. This is a win for all parties involved! After properly connecting the piping, the hood front is simply snapped back on with Tensos giving flexibility in the future if access would be required again.”

Chad Kramer, Owner of Retrotech Construction, Delano, MN



How it works:



1. Lay out and machine P-System slots for top edge of front panel



2. Transfer marks from front access panel to upper unit

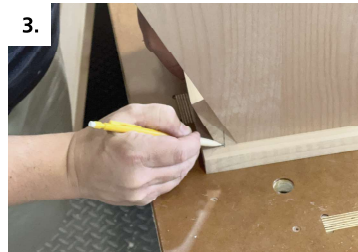

3. Transfer center line of slots to upper unit

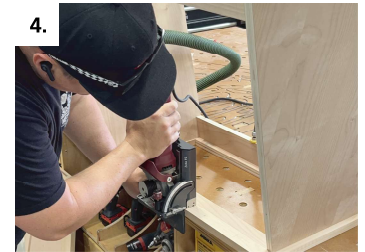

4. Machine P-System slots in upper unit

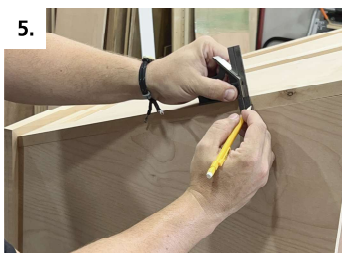

5. Lay out location for Clamex P-14 slots



6. Machine slots in edge of hood frame uprights



7. Machine slots on back side of front access panel

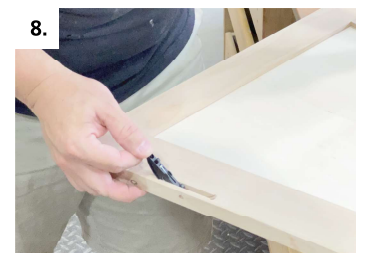

8. Install Clamex connectors; male half on the access panel

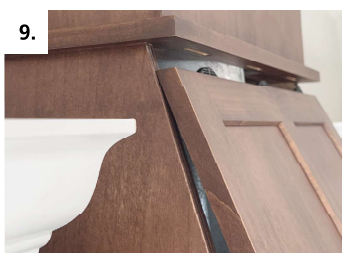

9. Use Bisco connectors at top edge for alignment and positioning



10. Slide top of access panel into place



11. Hinge access panel down to bottom of frame

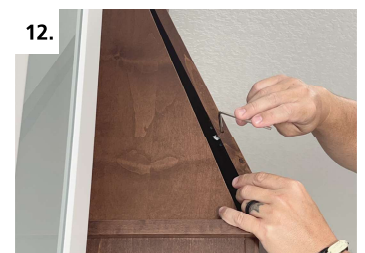

12. Use Clamex to secure or remove front access panel

Lamello

P-System tools, connectors & accessories

For in-depth Lamello how-to videos, visit our Lamello Lessons YouTube channel



Zeta P2 biscuit joiner	Art. No.
In Systainer, with carbide cutter and drill jig	101402S
In Systainer, with diamond cutter and drill jig	101402DS



Zeta P2 cordless biscuit joiner, DP (diamond)	Art. No.
In Systainer, incl. 2 batteries and charger	101801SD
In Systainer, without batteries, without charger	101800SD



P-System connector assortment professional	Art. No.
Includes: 80 pairs Clamex P-14, 80 pairs Tenso P-14 incl. clip, 60 pairs Clamex P14/10 Medius, 20 pieces Bisco P-14, Tenso P-14/10 preload tool, Systainer II T-Loc incl. compartment dividers	145314



P-System connector assortment basic	Art. No.
Includes: 120 pairs Clamex P-14, 30 pairs Clamex P-14/10 Flexus, 30 pairs Clamex P-10, 80 pairs Tenso P-14 incl. clip, 30 pairs Tenso P-10 incl. clip, 20 pieces Bisco P-14, 20 pieces Bisco P-10, 80 pairs Divario P-18, Divario installation tool/drill/marking gauge, Clamex, P installation tool, Tenso P-14/10 preload tool, Sortainer T-loc	145312



Divario P-18 Starter Set	Art. No.
In Systainer3, includes: Divario P-18, 80 pairs, drill, metal marking jig and installation tool	145551



Clamex P-14	Art. No.
80 pairs	145334
300 pairs	145346
1000 pairs	145356



Clamex P-14/10 Medius	Art. No.
80 pairs	145370
300 pairs	145371



Clamex P-10	Art. No.
80 pairs	145372
300 pairs	145373
1000 pairs	145374



Clamex P-14/10 Flexus	Art. No.
80 pairs	145315
300 pairs	145316
1000 pairs	145317



Bisco P-14	Art. No.
80 pieces	145301
300 pieces	145302
1000 pieces	145303



Bisco P-10	Art. No.
80 pieces	145304
300 pieces	145305



Divario P-18	Art. No.
80 pairs	145550
300 pairs	145560
1000 pairs	145570



Tenso P-14	Art. No.
80 pairs	145415
80 pairs, with preload clip	145415S
300 pairs	145425
1000 pairs	145435



Tenso P-14 preload clip	Art. No.
300 pieces	145426
1000 pieces	145436



Tenso P-10	Art. No.
80 pairs, with preload clip	145418
300 pairs, with preload clip	145428
1000 pairs, with preload clip	145438

Your distribution partner: